

## Gummi-Metall-Element, zylindrisch mit zwei Innengewinden Rubber-to-metal element, cylindrical with two internal threads

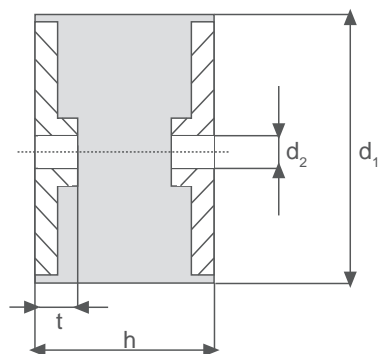

Artikel - Nr. Article - No.	d <sub>1</sub> (mm)	h (mm)	d <sub>2</sub> (mm)	t (mm)
GC-008x008	8	8	M3	3
GC-010x010	10	10	M4	4
GC-010x015	10	15	M4	4
GC-015x015	15	15	M4	5
GC-015x020	15	20	M4	5
GC-020x015	20	15	M6	6
GC-020x020	20	20	M6	6
GC-020x025	20	25	M6	6
GC-025x020	25	20	M6	6
GC-025x025	25	25	M6	6
GC-025x030	25	30	M6	6
GC-030x020	30	20	M8	8
GC-030x025	30	25	M8	8
GC-030x030	30	30	M8	8
GC-030x040	30	40	M8	8
GC-040x030	40	30	M8	8
GC-040x040	40	40	M8	8
GC-050x030	50	30	M10	10
GC-050x040	50	40	M10	10
GC-050x045	50	45	M10	10
GC-050x050	50	50	M10	10
GC-060x040	60	40	M10	10
GC-070x045	70	45	M12	12
GC-075x040	75	40	M12	12
GC-075x050	75	50	M12	12
GC-100x040	100	40	M16	16
GC-100x050	100	50	M16	16
GC-100x060	100	60	M16	16
GC-100x075	100	75	M16	16
GC-150x050	150	50	M16	16
GC-150x075	150	75	M16	16

Gummiwerkstoff: NR 55° Shore A (mittel), auch in Härten von 40° - 85° in 5° Schritten lieferbar  
 Metalle: Stahl verzinkt  
 Rubber material: NR 55° Shore A (medium), also available in 40° - 85° Shore (steps of 5°)  
 Metal parts: galvanised steel